

AVC-BHN81AVT

4K/8.4MP NETWORK IR WEATHERPROOF BULLET CAMERA

IP
CAMERA



FUNCTIONS

- H.265 Video Compression Technology
- 8.4MP (3840 × 2160) H.265 Full Real Time Encoding
- Max. Resolution: 3840 × 2160
- True Day & Night
- Up to 100ft. Night Time Viewing Distance
- 3.3 ~ 12mm MP Motorized Auto-focus Lens (ICR)
- 3D DNR, True WDR
- Video Analytics: Object Removal, Line Crossing Detection and Intrusion Detection
- Supports Defogging, HLC, BLC, Digital Image Stabilization and Image Correction for Various Situations
- 8 ROI Encoding
- microSD Card Local Storage, up to 128GB
- Supports Local CVBS / Analog Video Output (BNC) and Two-way Audio
- Supports PoE (4.5W / 8W with IR On)
- Supports Hardware Reset
- Supports Smartphone, iPad and Remote Monitoring
- Supports P2P Remote Connection
- IP66 Ingress Protection
- Supports Triple Streaming



DIMENSIONS

Unit: mm (Inch)

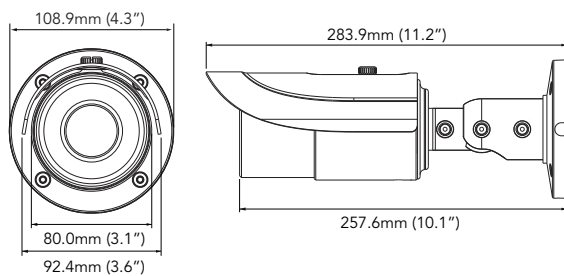

SPECIFICATIONS

DESCRIPTION	AVC-BHN81AVT
Image Sensor	1/2.5" CMOS
Image Resolution	3840 × 2160
Electronic Shutter	1/25 s ~ 1/100,000s
Auto Iris	Fixed Iris
Min. Illumination	0.01Lux @F1.2, AGC On; 0Lux with IR
Lens	3.3 ~ 12mm MP Motorized Auto-focus Lens (ICR)
Viewing Angle	Horizontal View Angle: 97.5° ~ 38.5°
Lens Mount	Ø14
Angle Adjustment	Any angle
IR Distance	100ft.*
Day & Night	True
Wide Dynamic Range	Digital WDR
Backlight Compensation (BLC)	Yes
HLC	Yes
Defogging	Yes
Digital NR	2D / 3D DNR
Image Setting	ROI, Saturation, Brightness, Chroma, Contrast, Wide Dynamic, Sharpen, NR, etc. Adjustable through client software or web browser
Video Compression	H.265 MP; H.264 BP / MP / HP; MJPEG
Resolution	8.4MP (3840 × 2160), 1080P (1920 × 1080), 720P (1280 × 720), D1, CIF, 480 × 240
Multi-Stream	60Hz : 8MP (1 ~ 30fps) / 1080P (1 ~ 30fps) / 720P (1 ~ 30fps) 50Hz : 8MP (1 ~ 25fps) / 1080P (1 ~ 25fps) / 720P (1 ~ 25fps)
Bit Rate	64Kbps ~ 16Mbps
Encode Mode	VBR / CBR
Encode Quality	Five Levels under VBR; Freely Adjustable under CBR
ROI	Each ROI to be configured separately
Audio Compression	G711A / U
Network	RJ45 × 1, 10M / 100M Self-Adaption
Video Output	CVBS (BNC × 1)
Audio	MIC In × 1, MIC Out × 1
Alarm Input	1 CH
Alarm Output	1 CH
RS-485	Yes
Network Protocol	TCP/IP, UDP, DHCP, NTP, RTSP, PPPoE, DDNS, SMTP, FTP
Connection Protocol	ONVIF, GB-T / 28181-2011
Remote Monitoring	Internet Explorer, CVMS, Mobile CVMS
Online Connections	Max. 10 Online Users
Storage	Network Remote Storage
Smart Alarm	Motion Alarm, Sensor Alarm
Video Analytics	Object Removal Detection, Line Crossing Detection and Intrusion Detection, etc.
PoE	Yes
Power Supply	DC 12V / PoE
Power Consumption (IR On)	< 8W
Power Consumption (IR Off)	< 4.5W
Operating Environment	-22°F ~ 140°F (-30°C ~ 60°C), 10% ~ 90% Relative Humidity
Weatherproof Rating	IP66
Dimensions	Ø4.3" × 11.2" (Ø108.9mm × 283.9mm)
Weight	2.45lbs

*IR distance range varies depending on the environment

FEATURES



Our IP cameras offer a complete set of input and output connectors for easy installation.

- Built-in PoE (Power over Ethernet) Port
- DC 12V Power
- CVBS Analog BNC Out
- Audio In
- Audio Out
- RS 485
- Alarm



Includes secondary test port for DC 12V Power In and CVBS Analog Out that connects inside the camera for easy adjustment and servicing.



A fully featured control board includes reset button, SD Storage, and DC IN/CVBS test port.

ACCESSORIES



AVM-EDMTS-W-TL1